

## Port characteristics

Port of Emmelsum

Date: 01.04.2024

1



# Port of Emmelsum

Voerde

ISPS-compliant port

**DeltaPort GmbH & Co.KG**

Port and rail supervision

Port office: 46483 Wesel, Hafenstr. 30, Germany

Business hours: Mo - Fr 07:00 am - 03:30 pm

Phone: +49 281 460 9612

E-Mail: [hafenmeister@deltaport.de](mailto:hafenmeister@deltaport.de)

Registration form vessels: [www.deltaport.de/en/ports&rail/ships registration form](http://www.deltaport.de/en/ports&rail/ships%20registration%20form)



## Connections:

Waterways:

Rhine river-km 813.24 (r.)

Freeways:

A3, A57, A59

National highways:

B8, B58

Public railway:

Port railway Emmelsum, railway county of Wesel

Connection to DB InfraGo- 2271 Oberhausen - Spellen

# Port characteristics

Port of Emmelsum

Date: 01.04.2024

2



## Quay facilities:

General ban on berthing, free loading and unloading

Height of the quay surface above water level [m]: → 13.10 minus level Wesel  
Water depth [m]: → Level Wesel plus 1.20

### Quay north

Length of berths: → 115 m (Quay wall)  
→ 100 m (dolphins)  
Quantity of berths (135 m): → 1  
Quantity of berths (cone): → 0

#### Permitted Payloads:

- generally on the quay surface: → 40 kN/m<sup>2</sup>
- max. permissible hawser pull per bollard/support cross: → 200 kN/m<sup>2</sup>

### Quay east north

Length of berths: → 135 m (Quay wall)  
Quantity of berths (135 m): → 1  
Quantity of berths (cone): → 0

#### Permitted Payloads:

- generally on the quay surface: → 20 kN/m<sup>2</sup>
- max. permissible hawser pull per bollard/support cross: → 100 kN/m<sup>2</sup> / 50 kN/m<sup>2</sup>

### Quay east south

Length of berths: → 180 m (Quay wall)  
Quantity of berths (135 m): → 1  
Quantity of berths (cone): → 0

#### Permitted Payloads:

- generally on the quay surface: → 20 kN/m<sup>2</sup>
- max. permissible hawser pull per bollard/support cross: → 100 kN/m<sup>2</sup> / 50 kN/m<sup>2</sup>

## Port characteristics

Port of Emmelsum  
Date: 01.04.2024

3



### Quay west

Length of berths:	➔	290 m (Quay wall)
Quantity of berths (135 m):	➔	2
Quantity of berths (cone):	➔	0

#### Permitted Payloads:

• generally on the quay surface:	➔	20 kN/m <sup>2</sup>
• in the quay wall area 4 m:	➔	10 kN/m <sup>2</sup>
• max. permissible hawser pull per bollard/support cross:	➔	100 kN / 50 kN

**Depending on the water level and wind strength, special provisions apply to the mooring of vessels (see port usage conditions, section 19).**

## Companies in the port:

### Quay north

#### Jerich Germany GmbH

Certified ISPS facility

Cargo handling/  
services:

Handling and storage of pulp, paper, break bulk and transports by rail, barge and truck

Container terminal / container depot

Handling plants:

Gantry crane (50 tons)

Operation time:

Su 10:00 pm - Sa 02:00 pm

Contact:

Phone: +49 281 16480-0

E-Mail: [office@jerich.com](mailto:office@jerich.com)

Address: Schleusenstr. 20, 46562 Voerde, Germany

### Quay east north

#### Sappi Logistics Wesel GmbH

Cargo handling/  
services:

Handling and storage of pulp, paper, break bulk and transports by rail, barge and truck

Container terminal / container depot

Handling plants:

1 x gantry crane (50 tons)

2 x container stacker (45 tons)

Operation time:

Mo - Fr 06:00 am - 10:00 pm

Open on Saturdays only by appointment

Contact:

Phone: +49 281 94410-0

E-Mail: [info@slw-logistics.com](mailto:info@slw-logistics.com)

Address: Schleusenstr. 36, 46562 Voerde, Germany

## Port characteristics

Port of Emmelsum

Date: 01.04.2024

4



### Quay east south

## Trimet Aluminium SE

Certified ISPS facility

Cargo handling/  
services:

Alumina, petroleum coke

Handling plants:

Pneumatic vessel discharger

Operation time:

24/7 (security service)

Contact:

Phone: +49 281 9421-0

E-Mail: [voerde@trimet.de](mailto:voerde@trimet.de)

Address: Schleusenstr. 11, 46562 Voerde, Germany

### Quay west

## Contargo Rhein-Waal-Lippe GmbH

Cargo handling/  
services:

Container terminal

High frequency of inland waterway vessel departures and arrivals  
towards Antwerp and Rotterdam

Lokal trucking

Handling dangerous goods

Reefer connections

Container repair

Handling plants:

Gantry crane (40 tons)

2 Reachstacker (45 tons each)

Operation time:

Mo - Fr

Office: 07:00 am - 06:00 pm

Handling: 06:00 am – 10:00 pm

Contact:

Phone: +49 281 460 987-0

E-Mail: [barge.emmelsum@contargo.net](mailto:barge.emmelsum@contargo.net)

Address: Schleusenstr. 42, 46562 Voerde, Germany

## Stenkamp Voerde GmbH / REWE Zentral GmbH

Certified IFS/BIO warehouse

Cargo handling/  
services:

Food import warehouse of the REWE Group for Germany-wide distribution  
to regional warehouses. Inbound via truck and container terminal.

Handling plants:

./.

Operation time:

Mo - Fr 07:00 am - 05:00 pm

Contact:

Phone: +49 281 94 80 38-0

E-Mail: [kontakt@stenkamp.net](mailto:kontakt@stenkamp.net)

Address: Schleusenstr. 18d, 46562 Voerde, Germany

# Port characteristics

Port of Emmelsum

Date: 01.04.2024



## Port railway:

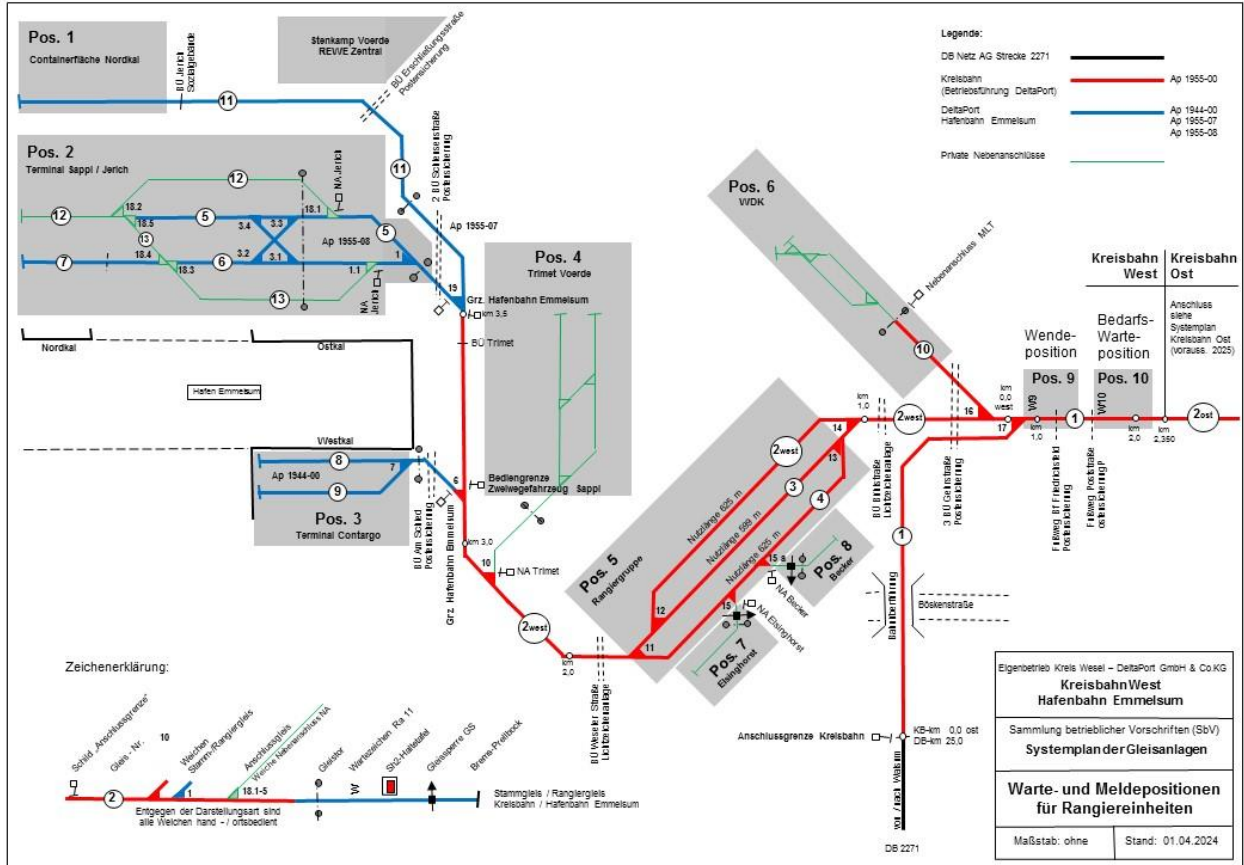

Connection via railway county of Wesel tot he rail network of DB InfraGO AG route 2271 Spellen - Oberhausen

<b>Route class:</b>	D4	Axle load:	➡	22.5 tons
		Line load:	➡	8.0 tons/m
<b>Sidings:</b>	Shunting group west	Track 2 west	➡	625 m
		Track 3	➡	599 m
		Track 4	➡	625 m
<b>Loading tracks:</b>	Quay north/Quay east	Track 5/12	➡	765 m
		Track 6/7	➡	765 m
		Track 11	➡	600 m
		Track 12	➡	490 m
		Track 13	➡	338 m
	Quay west	Track 8	➡	350 m
	Track 9	➡	350 m	